



26 ELIZABETH ST
LIVERPOOL

PUBLIC ARTWORK OPPORTUNITIES REPORT

CONTENTS

BABER

INTRODUCTION

SITE CONTEXT

The Development	04
Architectural Vision	05
About the Precinct	06
Location and Access	07
Site Characteristics	08
Heritage and History	09

VISIONING 10

Public Art Policy Alignment	11
Curatorial Vision	12

CURATORIAL THEMES 13

Overview of Artwork themes	14
----------------------------	----

ARTWORK OPPORTUNITIES 15

Overview	16
Landscape / Furniture	17
Vertical planes / Boundary Wall	18

IMPLEMENTATION 19

Indicative Public Art Process and Timeline	20
--	----

CONTACTS 20

INTRODUCTION

BABER

Baber Studio are a specialist consultancy who offer services in Design, Curatorial Services and Public Art Project Management. Their specialist services focus on interdisciplinary projects combining architecture and site specific artworks. The following Public Art Opportunities Report has been prepared for the 26 Elizabeth Street, Liverpool Development.

The intention of the report is to identify the most suitable artwork types with proposed locations for artwork integration. The report acknowledges the value that public artworks make in place making and the support they provide to the overall architecture intent. Through the following artwork recommendations it is anticipated that the whole of the Liverpool community will benefit.

BABER

SITE CONTEXT



SITE CONTEXT

The Development

The proposed development consists of a 36 storey tower, incorporating a five storey podium containing lobbies, commercial tenancies and car parking, a four storey hotel, a large resident's amenity level, a multi-residential tower with a mix of 1, 2, 3 and 4 bedroom apartments across 25 levels, and a roof top bar and restaurant. Entry to the building is via a generous, newly created pedestrian plane to the north and east of the site. The commercial lobby and retail offering address Elizabeth Street and provide an opportunity for outdoor dining and streetscape activation. The street address at Elizabeth Street is well positioned with an inviting landscape area.

A proposed link on the eastern boundary extends the frontage for the hotel, residential and restaurant lobbies, while creating a sheltered drop off zone and potential for links further through the block. This attractive street frontage links to the greater community offering a place to live, work and visit. The laneway continues to play an important role in activating the edges and increasing the overall frontage. It is anticipated that the laneway will make a future connection to the south.

The development will be home to hundreds of local people, and is well supported through the commercial and retail opportunities at the ground floor. The location is well connected to parks, the hospital and the university making this a significant development within the Liverpool precinct. The Public Art Strategy will ensure a benchmark aesthetic contribution to the development, as well as contributing to a vibrant community.

BABER



SITE CONTEXT

Architectural Vision

The Liverpool CBD is a City in a state of change, and flux. A city with significant history is transitioning to a major centre, with a very unique geography and climate to be considered. The design intent delivered a contemporary, Western Sydney residential tower that is a civic balance between high quality internal amenity for residents, with access to daylight and breezes, balanced by the complexity and engineering lead requirements.

The tower, is in the creation of unique identities for each of the disparate uses that a building of this type would attract and require to make a contribution to the activation of the city around it. The tower uses details at the macro city level and also at the human scale at the ground level. The concept of the building clearly expresses each of the uses housed within, such that the complexity of mixed use is embraced, but then carefully and particularly crafted into a contemporary architectural outcome. It uses robust and honest materials of natural concrete, and appropriate climatic devices that create deep shade elements. The predominance of precast concrete is deliberate and balanced design approach. Precast concrete is a familiar material, used in a unfamiliar, almost traditional way to create mass and void, solid and light. As the building gets closer to the ground plane, the level of detail and fenestration, along with the programmatic elements chnages to adapt and enhance its surrounds. The intensity of aesthetic and use, adjusting and tuning the closer to the public domain.

The uses, all combining to maximize any and all potential of the site, creating the potential for energy and injection of life into the expanding Liverpool CBD experience. The concept is therefore a tower that not only can make a positive contribution to the city at the street level, but at the broader city scale, performing the dual role that significant towers must satisfy to create a new skyline for Liverpool.

BABER



SITE CONTEXT

BABER

About The Site

The site consists of two titles on Elizabeth Street, and has combined site area of 3082m². It is located within heart of Liverpool City and is well placed to take advantage of the growing CBD. Within walking distance of the site are several key institutional and retail precincts, along with the open space on offer in Bigge Park and surrounding amenity. In close proximity are major public transport links into the broader Sydney network, and connections to highway infrastructure.

The Opportunity The large site in the centre of Sydney's third CBD presents an opportunity to create a landmark mixed use development with ample activation on the ground plane and unique restaurant at its crown offering sweeping views over the city and beyond. The site will be developed to scale with the broader context of high rise buildings, and in line with the vision for Liverpool.









SITE CONTEXT

Location and Access

The site is well located for proximity to several public transport options. The Liverpool train station is a 600m or 8 minute walk from the site, offering connections to Sydney CBD and the greater Sydney area. Locally, there are several bus routes on the streets around the site and bus stops for key routes are located within 100m of the site.

Major roads link the site to the Hume Highway, which allows easy access to key roads to surrounding suburbs and the broader Sydney context.

Legend

-  Subject site
-  Recreational Space/ Parks
-  Major Roads
-  Train Station
-  Train Route
-  Bus Stops
-  Bus Routes



The Liverpool city grid is marked by large block lengths, with some smaller, vehicular focused laneways. Redevelopment and consolidation of lots has reduced the permeability of the blocks in the subject sites locality. As part of the proposed future character of the blocks between George, Elizabeth and Bigge streets, a new East-West laneway is proposed that will take vehicular servicing from Elizabeth street to enhances its pedestrian character and increase the permeability of the main block. An additional north-south shared link is created by the subject development to enable a future link towards the south and The amenity of the main retail core of Liverpool mall, and Westfield shopping centre is close adjacent to the West, with the open space of Bigge Park a similar distance to the East. These components of the proposal will unlock the ability for the two adjacent sites to add further to the amenity at ground level of the CBD locale.



SITE CONTEXT

Heritage and History

Indigenous Heritage

The traditional custodians of the area now known as Liverpool are the Cabrogal clan of the Dharug Nation, and also accessed by peoples of the Dhurawal and Dharug Nations. These tribes knew the area as Gunyungalung and evidence suggests they have been here for up to 40,000 years.

The Collingwood precinct at Liverpool has been named a significant Aboriginal Place, which was a significant meeting place for the Dharawal, Gandangara, and Dharug people.

European Settlement

Liverpool was founded on the 7th of November 1810 by Governor Lachlan Macquarie as Australia's fourth oldest town after Sydney, Parramatta, and Hobart; and the first free planned settlement in Australia. Macquarie named Liverpool in honour of the Earl of Liverpool, Robert Banks Jenkinson, who was Secretary of State of the Colonies at the time. Emancipated convict and architect Francis Greenway was commissioned by Macquarie to design two of Liverpool's notable buildings: St Luke's Anglican Church and the Liverpool Hospital (now Liverpool Technical College).

In 1856 the great southern railway reached Liverpool, catalyzing its agricultural and transportation activity and establishing it as a satellite town with an economy based on poultry farming and market gardening. In 1910 Challenge Woollen Mills opened in the old paper mill. It remained the backbone of the local economy for decades until its closure in 1974.

Modern History

In the 1950's Sydney's urban sprawl reached Liverpool and transformed it into an outer suburb of greater Sydney with a high working class population and numerous manufacturing facilities.

In the First World War extensive military training activities took place in and around Liverpool and nearby Holsworthy, which also housed and provided training facilities for thousands of troops in World War II.

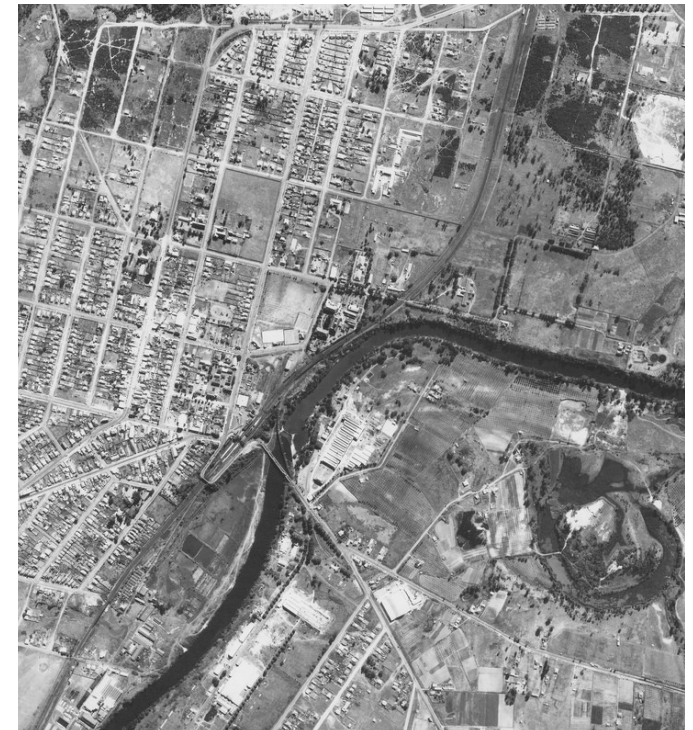

BABER



VISIONING

Public Art Policy Alignment

Liverpool City Council's vision for Cultural Strategy is to support and develop a thriving creative culture in Liverpool. It provides a platform to articulate priorities in the arts and culture which in turn transform the area into a vibrant and engaging city. The overall cultural strategy is driven by four directions:

- Enhance
- Generate
- Promote
- Celebrate

Public art for 26 Elizabeth Street in Liverpool will support this vision showcasing and developing a creative platform for the public to engage with. The proposed artwork at 26 Elizabeth Street will appeal to the growing and diverse community which surrounds.

In line with other standards for 'Public Art Planning' a contribution of between 0.05% and 0.25% of the construction cost will be contributed towards public artwork on this project.



Curatorial Vision

The Curatorial Vision for the development is based on a contextual analysis, including urban character, community aspirations, environmental considerations and relativity to the end users at 26 Elizabeth Street. The overall Curatorial Vision ensures that the public art has an overarching direction and that engaged artists can work towards this unifying theme.

CURATORIAL THEME: **Flourish**

Flourish as a noun by definition describes a “bold or extravagant gesture or action, made especially to attract attention.” Often used as a verb, the word **Flourish** is a positive reference to growing or developing in a healthy or vigorous way, especially as a result of a congenial environment.

Flourish speaks to the community at Liverpool who thrive, grow and contribute positively to the locale. Flourish speaks on a personal level about positive exchange between habitants at 26 Elizabeth Street. It also reflects on an onward and upward achievement of ideas and visions that have the right environment to flourish. Flourish is positive growth and builds on healthy connections. For those that call 26 Elizabeth Street their home, we imagine that their outward looking experience would encompass an ability to **Flourish**. Businesses that reside at 26 Elizabeth Street would also **Flourish** in their connection to the community.

Flourish connects with the architectural and landscape visioning, whereby newly created generous pedestrian planes, allow public to flourish in their street level activities. There are opportunities to **flourish** amongst the outdoor dining and streetscape activation, making meaningful connections within the broader context.

Flourish invites artwork to be vibrant, positive, energizing and inspiring. Above all the Curatorial theme of **Flourish** signals to all that this locale is supportive and is founded by a positive environment.



Curatorial Themes

The following themes have been developed from the overall Curatorial Rationale of **Flourish** as sub-themes for artists to gain additional inspiration, and a way of fine tuning their concepts to the greater project vision.

GROWTH

Concepts to expand the idea of growth, and the support of a growing culture whereby individuals can flourish through a nourishing environment. This ideal environment is optimistic in its outward public face and inwardly through metaphysical growth and changes.

- Growth through nature and growth through personal development, with links, patterns and layering of growth details
- Detailing the natural flora and fauna of the area, based on the history of the market gardens in the area and the introduction of other species
- Warm hearted approach to optimism that is an attitude which can nurtured

POSITIVE EXCHANGE

Concepts to draw inspiration on the positive outcomes that are generated through the exchange of ideas. Positive changes are made within cultures through the exchange of customs and trade. It is through these exchanges that a community can embrace diversity.

- Concepts of exchange between cross-cultures and ideas
- Imagery that communicates a welcoming place for the exchange of ideas
- Qualities of positivity through colour composition and the exploration of layering

OPPORTUNE ENVIRONMENT

Concepts to expand the idea of fertile environments and their ability to foster opportunities.

- Opportune has connotations of luck and good fortune, an expression of imagery for taking opportunities
- Patterning and imagery of the environment in contrast with the built environment
- Lighting elements to highlight a night environment experience

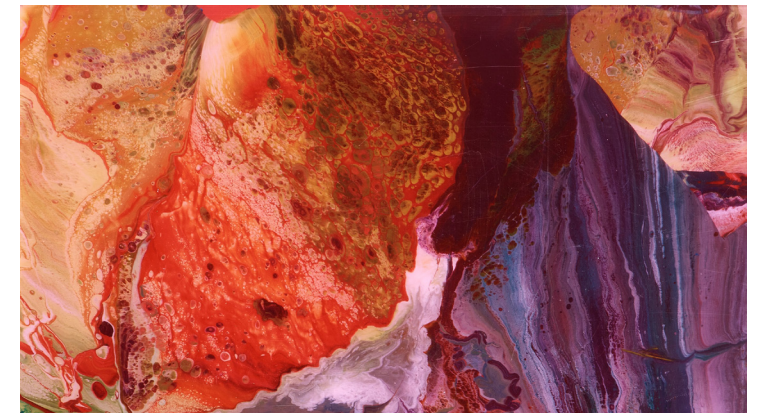

ARTWORK OPPORTUNITIES

The background of the slide is a vibrant, abstract composition of numerous overlapping semi-circular shapes. These shapes, which resemble thick, curved slices of material, are arranged in a dense, layered fashion that creates a sense of depth and movement. The color palette is diverse and saturated, featuring a wide range of hues including deep blues, bright reds, sunny yellows, lush greens, and rich purples. Some shapes are solid colors, while others have a slightly translucent or metallic sheen, reflecting light in a way that adds to the visual complexity. The overall effect is a dynamic and artistic visual field that frames the central text.

ARTWORK OPPORTUNITY

BABER

Overview

Two key opportunities have been identified for future public artworks. It is anticipated that either of these ideas could be further developed as part of the Council's requirements for this new development.

The ground floor plan featured right provides an overview of the areas best suited to artwork opportunities. These two sites take advantage of site lines and visual access by all general public. The highlighted areas show the extent of each artwork opportunity possible integration and placement. The two artwork opportunities include:

- Landscape / Furniture
- Vertical Plane

These two artwork opportunities are suited to the scale and footprint of the development, allowing easy accessibility for the public to appreciate the public artwork contribution. The public artwork will resonate both with the development intent and with the general locale. The following pages investigate in detail the key artwork opportunities.



ARTWORK OPPORTUNITY

Landscape / Furniture Elements

Supported through an innovative and contemporary approach, the art as a landscape element is distinctive and original. The landscape shaping and innovation is bold and memorable. The art is formed from landscaping components both living and built. Throughout the landscape, bespoke furniture is sited as welcoming additions for the public to enjoy. These bespoke furniture artworks are robust and unique.

- Sculptural forms made from the landscape (growing and built works)
- Bespoke furniture that is aesthetically pleasing and robust

ARTWORK ASPIRATIONS

- Distinctive furniture features enable and foster a social space, surrounded by a landscape
- Stylish and sophisticated which speaks of the Australia landscape
- Part of the overall design, a contributing asset that is sympathetic to the human scale.
- Potential to incorporate lighting for night time effect

BABER

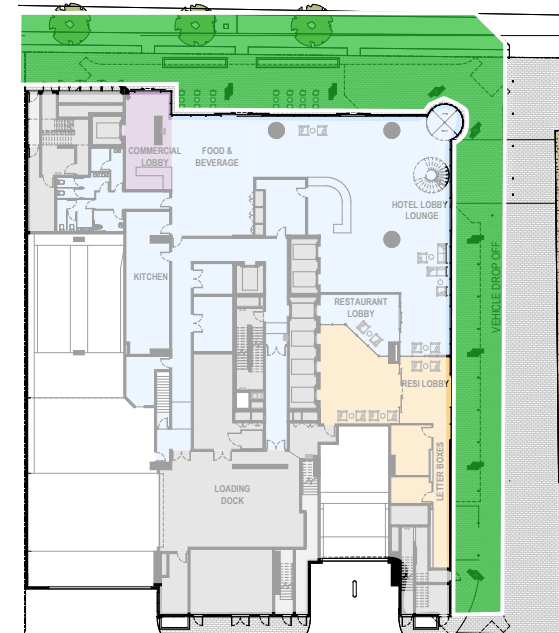
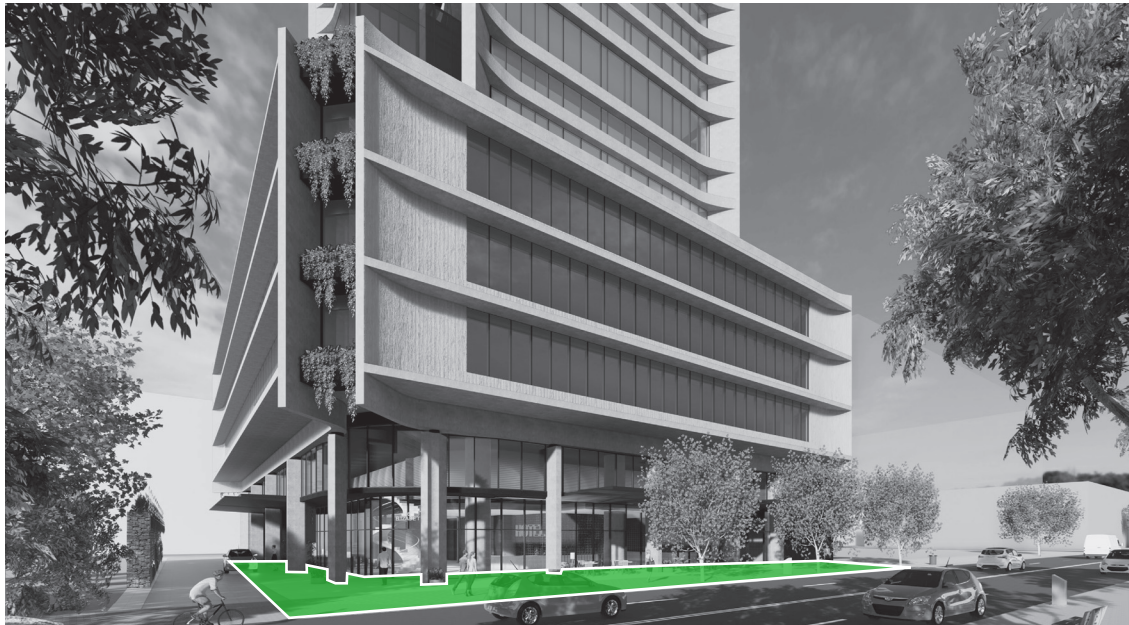

ARTWORK OPPORTUNITY

Vertical planes / Boundary Walls

The laneway increases the overall frontage and offers opportunities for the public to use a thoroughfare accessed from Elizabeth Street. Building a boundary wall is an extension of the project, and will have the sophistication of the general design. This vertical wall, offers an artwork opportunity that could be alongside the landscaping. It is anticipated that the vertical plane artwork could be developed as the following

- Aesthetic public art wall that offers a light source
- Public artwork wall that is sympathetic to the landscape

ARTWORK ASPIRATIONS

- Distinctive vertical feature that is inviting as a laneway visual
- An artwork that stands alone yet matches the sophistication of the adjacent architecture
- Tactile and rich materiality, a contributing asset that is sympathetic to the human scale
- Potential to incorporate lighting for night time effect

BABER

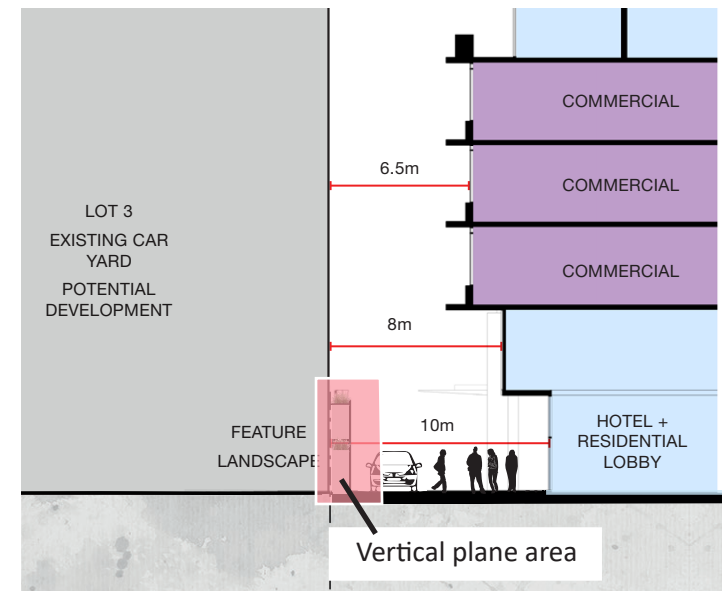
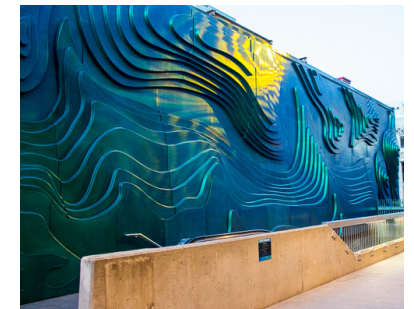
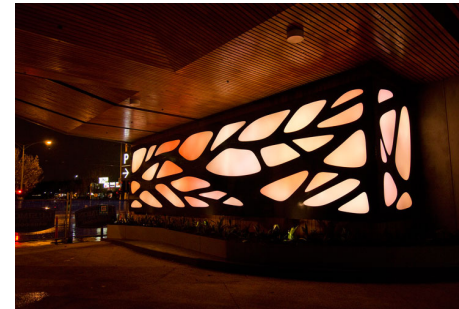

IMPLEMENTATION



Public Art Process and Timeline

ART PLANNING

ART STRATEGY
4-6 WEEKS

- Project initiation meeting with key stakeholders
- Review of development's design documents
- Research into local culture, history and environment
- Development and documentation of Art Strategy with identification of art locations and benchmarking
- Implementation planning including development of; art budget guide, art process and initial program, maintenance and sustainability methodologies

ARTIST PROCUREMENT
4-6 WEEKS

- Confirm approved Art Opportunities to proceed
- Facilitate and support artist shortlisting and selection process with Client
- Confirm Artist availability
- Develop Artist Briefing documents

DESIGN

CONCEPT DESIGN
8-10 WEEKS

- Contract selected Artist
- Brief contracted Artist
- Artist support for research and investigation, concept development, selection of materials, colours and scale
- Concept Design presentation including narrative descriptions, sketches and visualisations prepared by artists
- Preliminary construction program and budget
- Management of Client review and selection of Concept Designs

DESIGN DEVELOPMENT
10-12 WEEKS

- Artist support for further materials investigation
- Preliminary engineering advice and liaison with design consultants and construction team
- Final models and computer generated visualisations (as required)
- Material selection and fabrication budget review with client
- Management of Client review and approval of Developed Designs

CONSTRUCTION

CONSTRUCTION/ DELIVERY
14-22 WEEKS

- Full construction documentation and engineering certification including samples and prototypes (as required)
- Final construction budget review with client
- Project management and budget control of artwork construction
- Management of fabrication process, including:
- Artwork fabrication
- Client approvals during construction
- Quality control
- Transportation to site
- Maintenance advice and development of Maintenance Manual/s
- Attribution plaque

CONTACTS

BABER

Baber Studio offer consultancy services Design, Curatorial and
Public Art Project Management Services

Visit the website for latest project details
www.baberstudio.com.au

Baber Studio Contacts

Monique Baber

Co-Director

P: 07 31929640

E: mb@baberstudio.com.au